

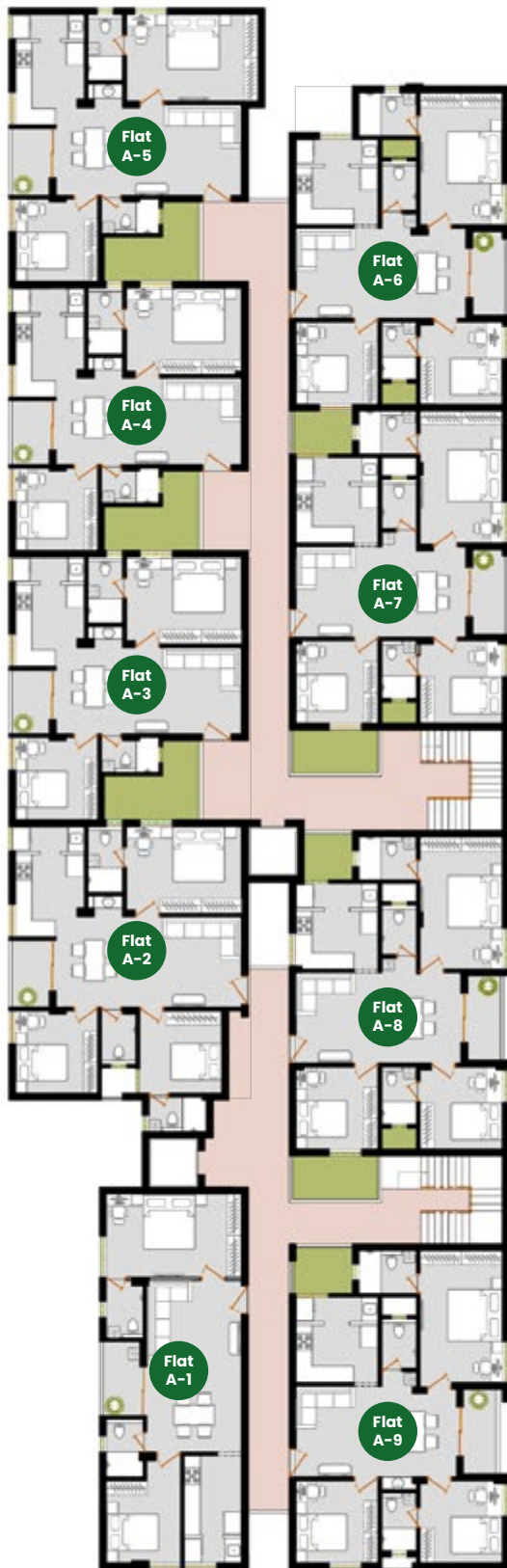

Full Typical Floor Plan



Block A



Block B





Block - A Flat A - 1

2 BHK - West

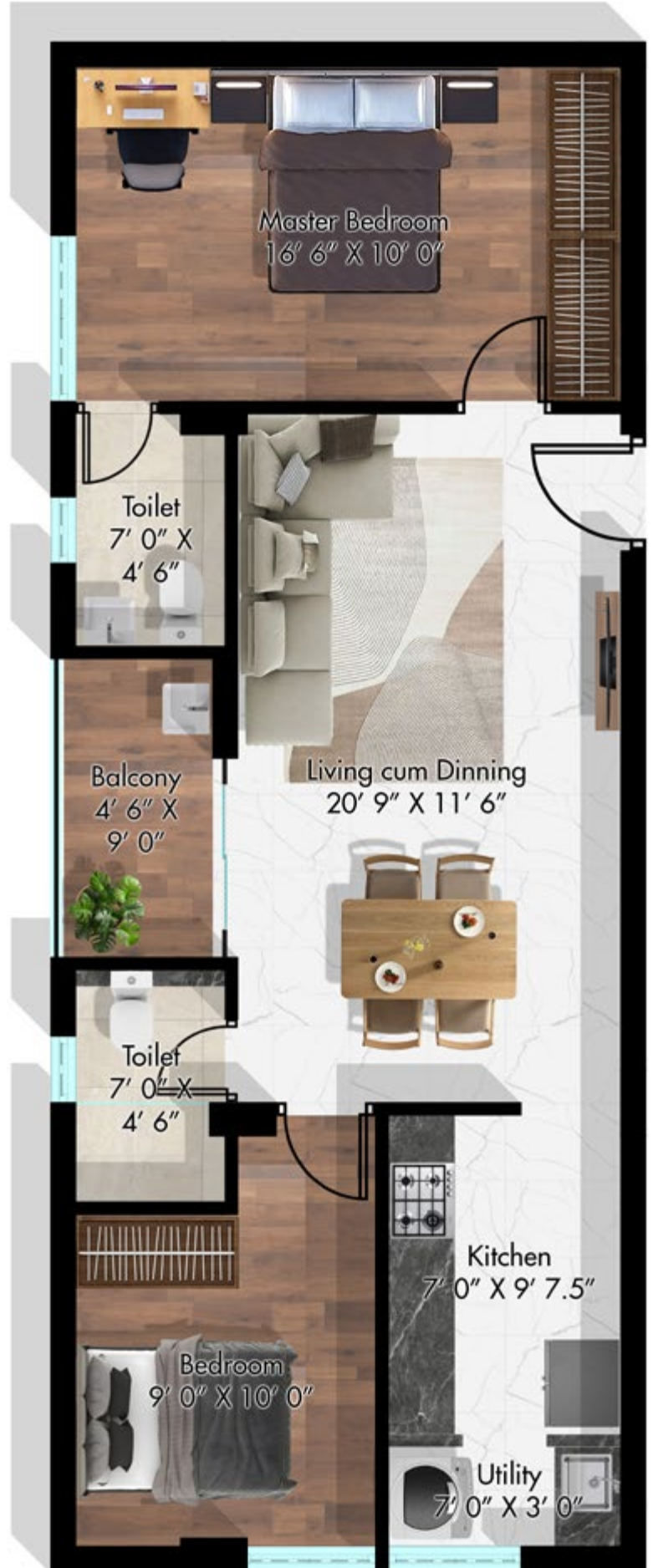

Flat - 101
Area-1014.07 Sq.ft

[Go Back to Full Layout](#)

Block - A
Flat A - 2
3 BHK - West



Flat - 102
Area-1210.30 Sq.ft

◀ **Go Back to
Full Layout**



Block - A Flat A - 3

2 BHK - North



Flat - 103
Area- 1003.29 Sq.ft

[Go Back to Full Layout](#)



Block - A Flat A - 4

2 BHK - North



Flat - 104
Area- 1003.29 Sq.ft



Go Back to
Full Layout



Block - A
Flat A - 5
2 BHK - North



Flat - 105
Area-1051.35 Sq.ft

[Go Back to Full Layout](#)



Block - A
Flat A - 6
3 BHK - East



Flat - 106
Area-1202.93 Sq.ft

[Go Back to Full Layout](#)



Block - A Flat A - 7

3 BHK - East



[Go Back to Full Layout](#)

Flat - 107
Area-1208.44 Sq.ft

Block - A
Flat A - 8
3 BHK - East



Flat - 108
Area-1197.07 Sq.ft

◀ Go Back to
Full Layout

Block - A Flat A - 9

3 BHK - East



Flat - 109
Area-1200.30 Sq.ft

◀ Go Back to
Full Layout



Block - B Flat B - 1

3 BHK - West



Flat - 111
Area-1157.82 Sq.ft

◀ Go Back to
Full Layout

Block - B
Flat B - 2
3 BHK - West



Flat - 112
Area-1199.59 Sq.ft

◀ **Go Back to
Full Layout**

Block - B
Flat B - 3
3 BHK - West



Flat - 113
Area-1206.80 Sq.ft

◀ Go Back to
Full Layout



Block - B
Flat B - 4
3 BHK - West



Flat - 114
Area-1199.59 Sq.ft

[Go Back to Full Layout](#)

Block - B
Flat B - 5
3 BHK - North



Flat - 115
Area-1200.09 Sq.ft

◀ **Go Back to
Full Layout**



Block - B Flat B - 6

3 BHK - East



Flat - 116
Area-1170.83 Sq.ft

[Go Back to Full Layout](#)

Block - B
Flat B - 7
3 BHK - East



[Go Back to Full Layout](#)

Flat - 117
Area-1170.83 Sq.ft



Block - B Flat B - 8

3 BHK - East



Flat - 118
Area-1170.83 Sq.ft

[Go Back to Full Layout](#)



Block - B
Flat B - 9
3 BHK - East



[Go Back to Full Layout](#)

Flat - 119
Area-1188.35 Sq.ft



a project of



For Further details

Contact Info

Phone - **+91 90039 55028**

Email - enquiry.nithyaclover@gmail.com

Sales Office - Nithya clover

24,puliyakulam road,
Ramanathapuram.
Coimbatore 28, TN, India

Head Office - Nithya Estates

23, Bharathi Park Road,
Saibaba Colony,
Coimbatore 43 , TN, India